



THE WESTIN
DETROIT METROPOLITAN AIRPORT

Celebrate or Innovate

Host your next Detroit-area event at The Westin Detroit Metropolitan Airport. We offer a variety of modern meeting rooms, and our recent renovation boasts multi-million dollar event and meeting space enhancements including additional small meeting space capacity, state of the art audio and visual capabilities and modern furniture to compliment your event and provide the best experience yet. With over 26,000 square feet of event space across 36 rooms, we offer countless ways to connect and collaborate in Detroit.

THE WESTIN
DETROIT METROPOLITAN AIRPORT

2501 WORLDGATEWAY PL,
DETROIT, MI 48242

T +1 734.942.6500

westindetroitmetroairport.com

Conference Level



ROOM NAME	DIMENSIONS	SQ. FT.	CEILING	THEATER	CLASS	BANQUET	CONF	U-SHAPE	HOL SQ	RECEP
ARMSTRONG	29' X 27'	711	10.4'	60	36	40	24	21	24	60
AVIATOR	20' X 18'	345	10.4'	30	18	10	10	—	—	30
CLARK BOARDROOM	15' X 37'	501	10.4'	—	—	—	12	—	—	—
DESOTO	23' X 18'	371	9.2'	28	15	20	10	—	—	30
DRAKE	16' X 18'	300	8'	37	21	30	10	8	—	—
CADILLAC	15' X 19'	300	8'	37	21	30	10	8	—	—
EARHART	32' X 54'	1,584	10.5'	150	50	90	39	36	42	120
EARHART A	32' X 27'	793	10.5'	72	36	40	24	21	24	70
EARHART B	32' X 27'	791	10.5'	72	36	40	24	21	24	70
HUDSON	23' X 25'	561	10.4'	50	24	30	18	15	18	50
LEWIS BOARDROOM	15' X 38'	510	10.4'	—	—	—	12	—	—	—
LINDBERGH BALLROOM	71' X 107'	7,323	13'	800	400	500	—	150	150	800
LINDBERGH FOYER	65' X 110'	5,176	15.5'	—	—	—	—	—	—	550
LINDBERGH A	71' X 36'	2,448	13'	250	120	150	50	57	66	250
LINDBERGH A - B	71' X 71'	4,867	13'	510	240	300	100	72	78	500
LINDBERGH B	70' X 35'	2,426	13'	250	120	150	50	57	66	250
LINDBERGH B - C	71' X 71'	4,882	13'	510	240	300	100	72	78	500
LINDBERGH C	71' X 36'	2,456	13'	250	120	150	50	57	66	250
MCNAIR	26' X 27'	620	10.4'	50	27	40	24	21	24	60
WRIGHT	29' X 54'	1,535	10.4'	120	50	100	39	36	39	120
WRIGHT A	29' X 27'	771	10.4'	70	30	40	24	21	24	75
WRIGHT B	29' X 27'	764	10.4'	70	30	40	24	21	24	75

Lower Conference Level

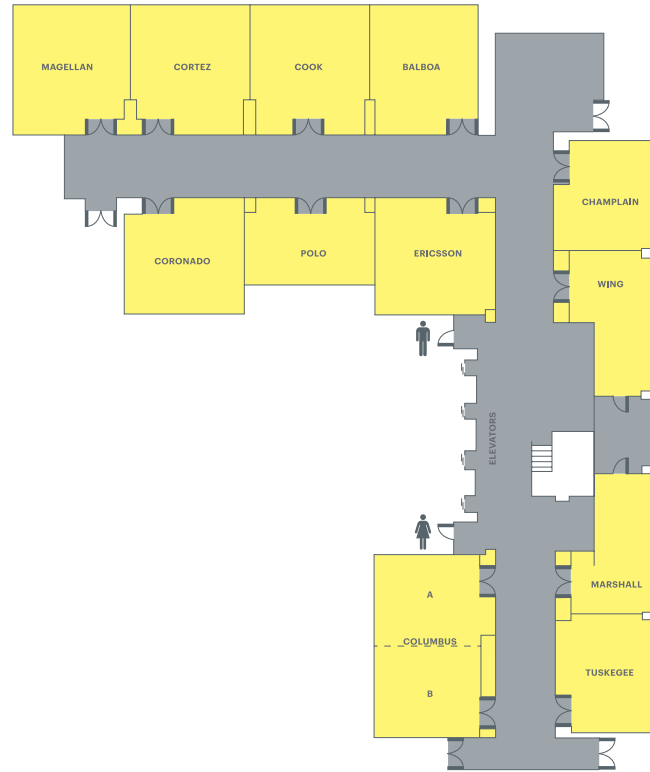

ROOM NAME	DIMENSIONS	SQ. FT.	CEILING	THEATER	CLASS	BANQUET	CONF	U-SHAPE	HOL SQ	RECEP
BALBOA	29' X 25'	705	9.6'	50	24	40	21	18	21	60
CHAMPLAIN	23' X 26'	566	9.9'	40	20	30	18	15	18	40
COLUMBUS	27' X 41'	1,010	9.4'	75	40	70	36	30	36	75
COLUMBUS A	27' X 21'	519	9.4'	30	18	30	18	15	18	40
COLUMBUS B	24' X 20'	491	9.4'	30	18	30	18	15	18	40
COOK	29' X 27'	740	9.8'	60	36	40	24	21	24	50
CORONADO	26' X 27'	662	9.4'	60	27	40	24	21	24	50
CORTEZ	29' X 27'	743	9.6'	60	27	40	24	21	24	50
ERICSSON	26' X 27'	664	10'	60	24	40	21	18	21	40
MAGELLAN	29' X 26'	719	9.6'	60	36	50	24	21	24	40
POLO	19' X 29'	525	9.4'	40	18	30	18	15	18	30
TUSKEGEE	23' X 27'	595	9.2'	50	27	30	21	18	21	50
WING & MARSHALL	23' X 82'	1,345	9.1'	—	—	—	—	—	—	90
MARSHALL BOARDROOM	20' X 31'	541	9.1'	—	—	—	12	—	—	—
MARSHALL WITH PART OF WING	20' X 50'	800	9.1'	—	—	—	—	—	—	80
WING	23' X 50'	814	9.1'	40	18	30	18	—	18	40

Departure Level

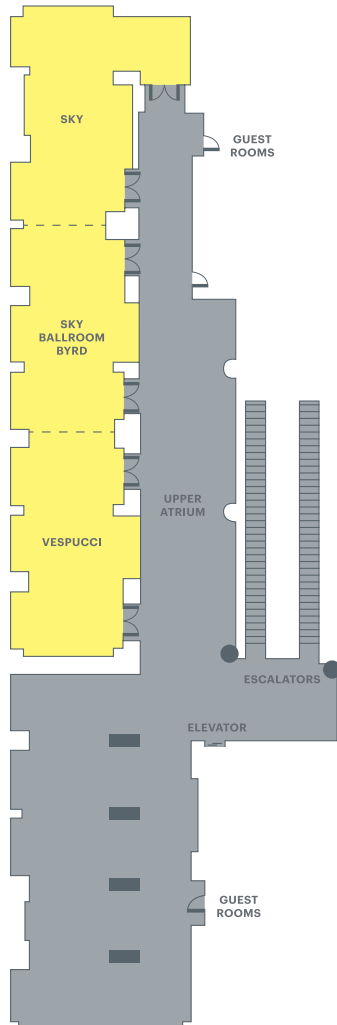

ROOM NAME	DIMENSIONS	SQ. FT.	CEILING	THEATER	CLASS	BANQUET	CONF	U-SHAPE	HOL SQ	RECEP
UPPER ATRIUM FOYER	43' X 128'	2,385	7.1'	—	—	—	—	—	—	250
SKY BALLROOM	34' X 125'	2,726	7.3'	200	100	140	66	80	—	250
BYRD	24' X 40'	837	7.3'	60	30	40	22	27	30	60
BRYD & SKY	34' X 82'	1,825	7.3'	—	—	—	—	—	—	120
SKY	34' X 42'	994	7.3'	60	30	40	22	27	30	60
VESPUCCI	24' X 43'	897	7.3'	60	30	40	22	27	30	60
VESPUCCI & BYRD	24' X 83'	1,732	7.3'	—	—	—	—	—	—	120

Lobby Level



ROOM NAME	DIMENSIONS	SQ. FT.	CEILING	THEATER	CLASS	BANQUET	CONF	U-SHAPE	HOL SQ	RECEP
FLIGHT DECK LOUNGE	61' X 83'	3,324	9.5'	—	—	120	—	—	—	150
LOBBY	151' X 59'	4,553	100'	—	—	120	—	—	—	250



Rooms at a glance

Guest Rooms: 404

Total Square Footage: Over 26,000 square feet

Largest Meeting Space: 7,330-square foot ballroom

Largest Meeting Space Capacity: 800

Amount of Meeting Rooms: 36 meeting rooms

FOR MORE INFORMATION CONTACT OUR SALES TEAM DIRECTLY AT:

westin.detroit@westin.com

or by calling 734.942.6500

THE WESTIN
DETROIT METROPOLITAN AIRPORT