



**LE DISTRICT**

• EST. 2015 •

# PRIVATE EVENTS

---

BROOKFIELD PLACE, 225 LIBERTY STREET, NYC

LEDISTRICT.COM

---



# EVENT CAPACITIES

| VENUE                  | COCKTAIL | SEATED |
|------------------------|----------|--------|
| LE DISTRICT BUYOUT     | 1500     | -      |
| JARDIN D'HIVER         | 500      | -      |
| L'APPART               | 50       | 32     |
| MARKET DISTRICT BUYOUT | 300      | -      |
| THE GRILL              | 75       | -      |
| THE GRILL TABLES       | 40       | -      |
| BAR A VIN              | 150      | -      |
| BAR A VIN EAST         | 75       | 30     |
| BAR A VIN WEST         | 75       | 22     |
| CAFÉ GOURMAND          | 35       | -      |
| LE BAR                 | 170      | -      |
| LE BAR EAST            | 40       | -      |
| LE BAR WEST            | 80       | -      |
| LE BAR SIGN            | 50       | -      |

| VENUE                 | COCKTAIL | SEATED |
|-----------------------|----------|--------|
| LIBERTY BISTRO        | -        | 100    |
| LIBERTY BISTRO WEST   | -        | 100    |
| LIBERTY BISTRO WEST 1 | -        | 60     |
| LIBERTY BISTRO WEST 2 | -        | 30     |
| LIBERTY BISTRO EAST   | -        | 30     |
| TERRACE BUYOUT        | 500      |        |
| ST TROPEZ BAR         | 50       | -      |
| PATIO WEST            | 80       | -      |
| PATIO WEST TABLE      | 20       | 20     |
| PATIO EAST            | 80       | -      |
| PATIO EAST TABLE      | 20       | 20     |
| LIBERTY OUTDOOR       | 100      | 50     |
| LIBERTY OUTDOOR NORTH | 50       | 25     |
| LIBERTY OUTDOOR SOUTH | 50       | 25     |
| GARDEN LOUNGE         | 60       | -      |
| GARDEN LOUNGE 1       | 30       | -      |
| GARDEN LOUNGE 2       | 30       | -      |
| LA CROISSETTE         | 75       | -      |



Request a Proposal

Virtual Tour



# convene

MEETING ROOMS



# convene

## MEETING ROOMS CAPACITIES

| 1ST FLOOR | DIMENSION [FT] | AREA [SQ FT] | CEILING HT [FT] | RECEPTION | THEATER | CLASSROOM | ROUNDS | U-SHAPE | PODS | HOLLOW SQUARE | EXHIBITION [8x10 BOOTH] |
|-----------|----------------|--------------|-----------------|-----------|---------|-----------|--------|---------|------|---------------|-------------------------|
| Hall 1    | 91' x 89'      | 7,572'       | 11'             | 700       | 615     | 285       | 456    | n/a     | 228  | n/a           | 33                      |
| Gallery 1 | 114' x 32'     | 8,556'       | 10'             | n/a       | n/a     | n/a       | n/a    | n/a     | n/a  | n/a           | 12                      |

### 2ND FLOOR

|         |           |        |     |     |     |     |     |     |     |     |     |
|---------|-----------|--------|-----|-----|-----|-----|-----|-----|-----|-----|-----|
| Hall 2  | 85' x 84' | 5,720' | 18' | 499 | 479 | 225 | 360 | n/a | 204 | n/a | 29  |
| Hub 1   | 40' x 28' | 1,014' | 16' | n/a | 72  | 45  | n/a | 36  | 56  | 36  | n/a |
| Hub 2   | 40' x 29' | 1,226' | 16' | n/a | 72  | 54  | n/a | 36  | 56  | 36  | n/a |
| Hub 3   | 40' x 24' | 1,187' | 16' | n/a | 72  | 54  | n/a | 36  | 56  | 36  | n/a |
| The Hub | 40' x 81' | 3,427' | 16' | n/a | 220 | 129 | 192 | n/a | 196 | n/a | 23  |
| Hub 4   | 45' x 26' | 1,056' | 12' | n/a | 60  | 36  | n/a | 24  | 42  | 36  | n/a |

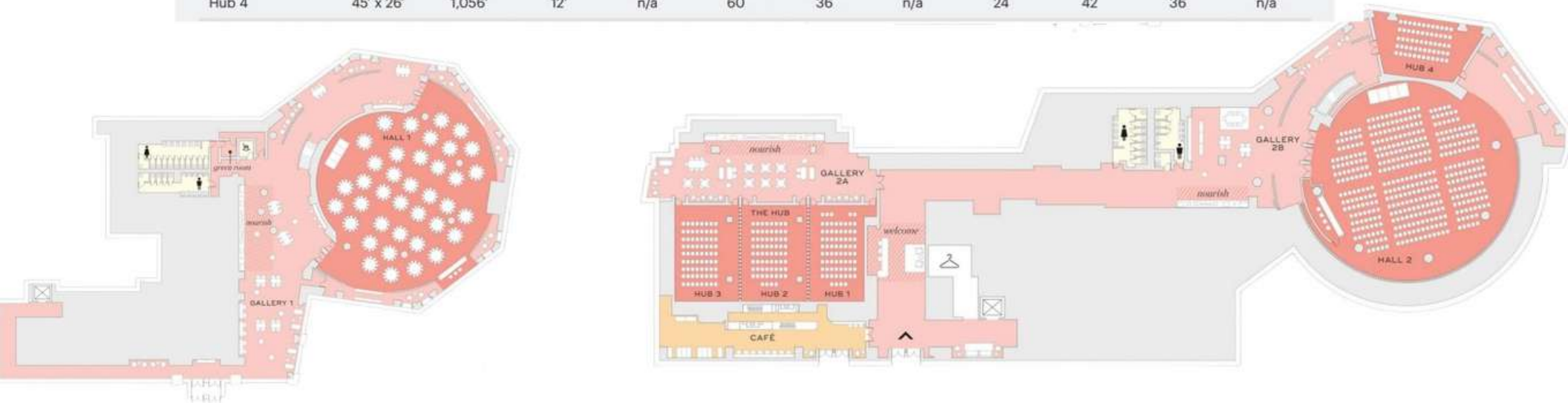

# JARDIN D'HIVER



# JARDIN D'HIVER



# JARDIN D'HIVER

## CAPACITY

|          |         |
|----------|---------|
| COCKTAIL | 500 PPL |
| SIT DOWN | 120 PPL |

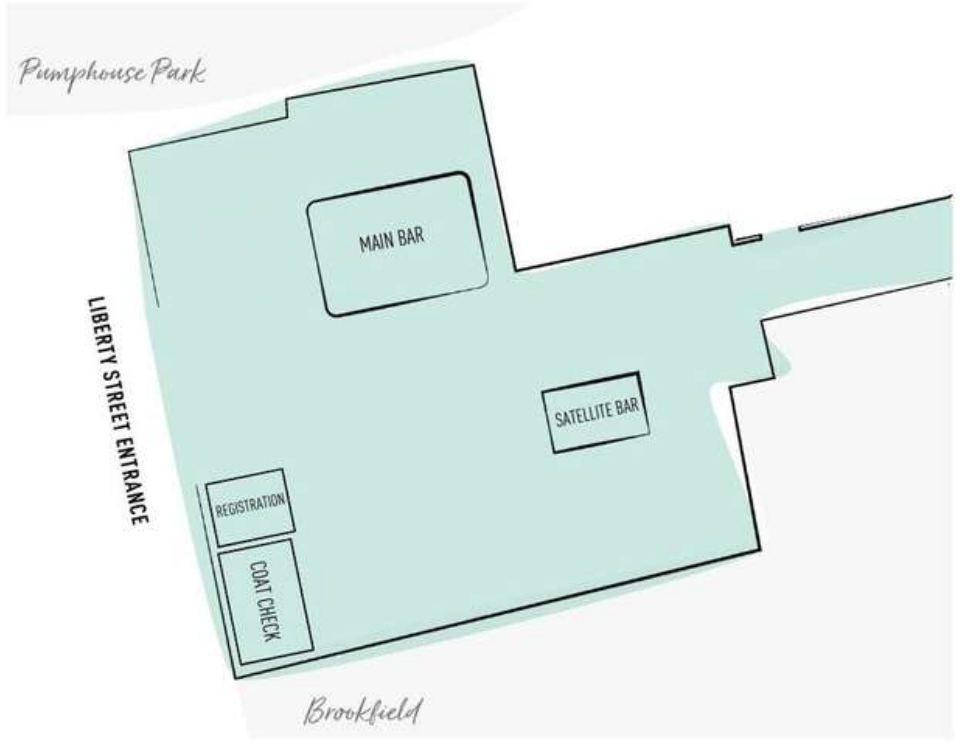

[Request a Proposal](#)

[Virtual Tour](#)



# L'APPART



MICHELIN STAR GUIDE  
2017, 2018, 2019, 2020, 2021



# L'APPART



MICHELIN STAR GUIDE  
2017, 2018, 2019, 2020, 2021





## CAPACITY

|          |        |
|----------|--------|
| COCKTAIL | 50 PPL |
| SIT DOWN | 32 PPL |



*Request a Proposal*

*Virtual Tour*

# THE MARKET BAR A VIN

34 WINES BY  
THE GLASS,  
EXPLORE FRANCE  
GLASS BY GLASS.  
SERVICE CONTINU



Happy Hour  
EVERYDAY FROM 4-6pm  
WINE BEER BUBBLES  
HOURS 1130m-400m



ÉPICES

# THE MARKET THE GRILL



# THE MARKET

## THE GRILL TABLES



# THE MARKET CAFE GOURMAND



# THE MARKET

The Grill  
Bar a Vin

## THE MARKET BUYOUT

|          |         |
|----------|---------|
| COCKTAIL | 300 PPL |
|----------|---------|

## THE GRILL CAPACITY

|          |        |
|----------|--------|
| COCKTAIL | 75 PPL |
|----------|--------|

## BAR A VIN CAPACITY

|                         |         |
|-------------------------|---------|
| COCKTAIL                | 100 PPL |
| BAR A VIN EAST COCKTAIL | 50 PPL  |
| BAR A VIN WEST COCKTAIL | 50 PPL  |

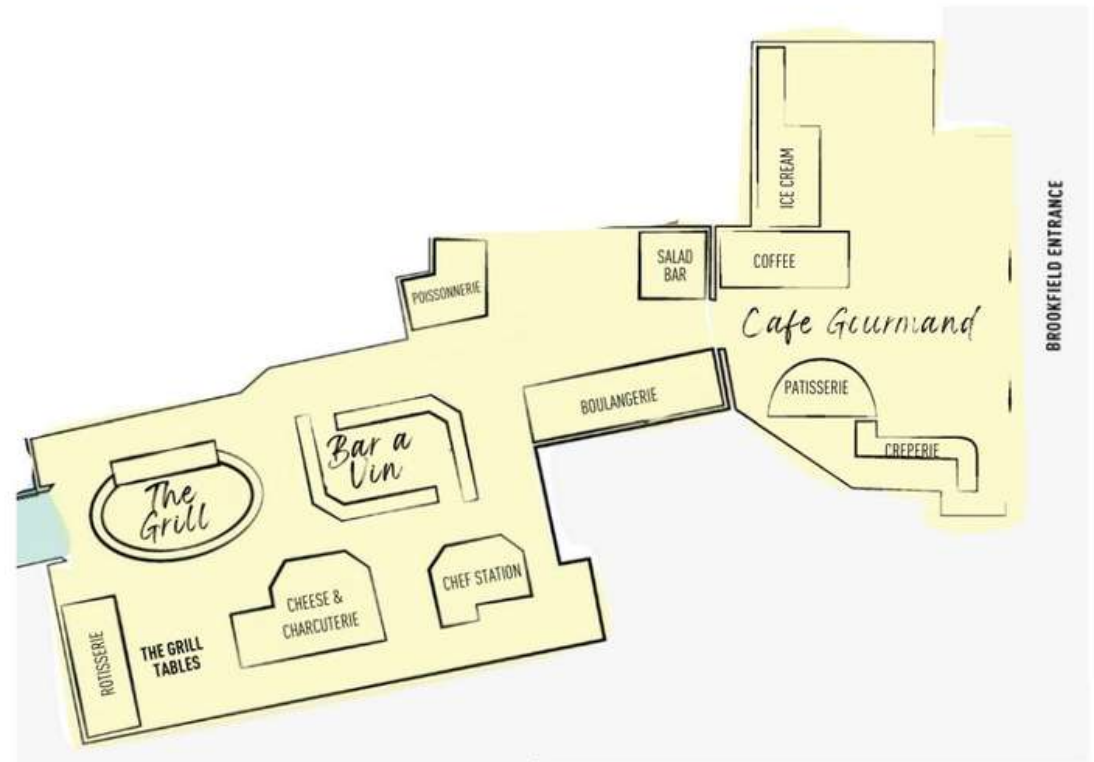

[Request a Proposal](#)

[Virtual Tour](#)



# LE BAR



# LE BAR



# LIBERTY BISTRO DINING ROOM





GARDEN LOUNGE



# GARDEN LOUNGE NORTH



# LA CROISSETTE BAR



# LIBERTY BISTRO

Le Bar

Liberty Bistro Dining

Liberty Bistro Terrace

## RECEPTION

|        |         |
|--------|---------|
| BUYOUT | 150 PPL |
| SEATED | 100 PPL |

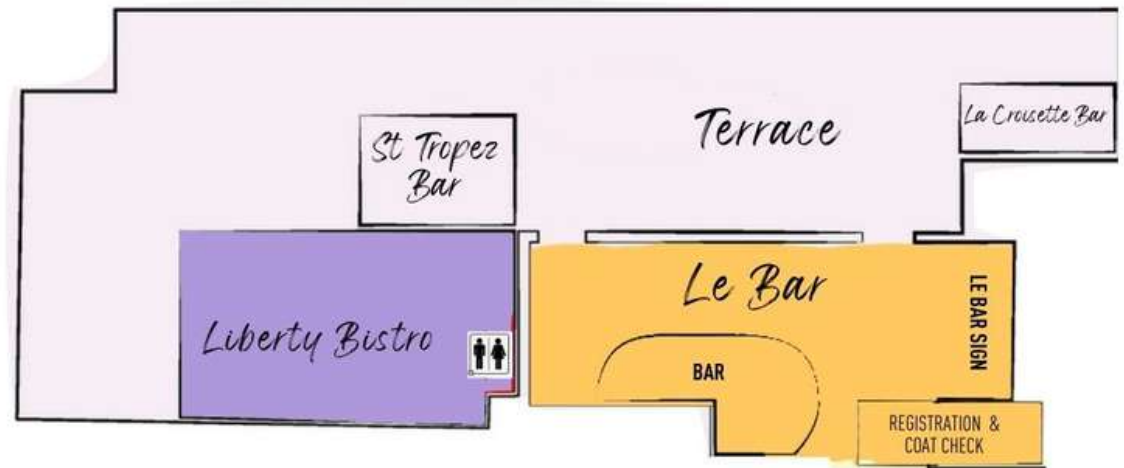

[Request a Proposal](#)

[Virtual Tour](#)